



## Guide to Two-Factor Authentication

---

### Enrollment Guide

Duo's self-enrollment process makes it easy to register your phone and install the Duo Mobile application on your smartphone or tablet.

Duo prompts you to enroll when you log into a protected VPN, server, or web application.

**Supported Browsers:** Chrome, Firefox, Safari, Internet Explorer 8 or later, and Opera.



#### 1. Welcome Screen

Click **Start setup** to begin enrolling your device.

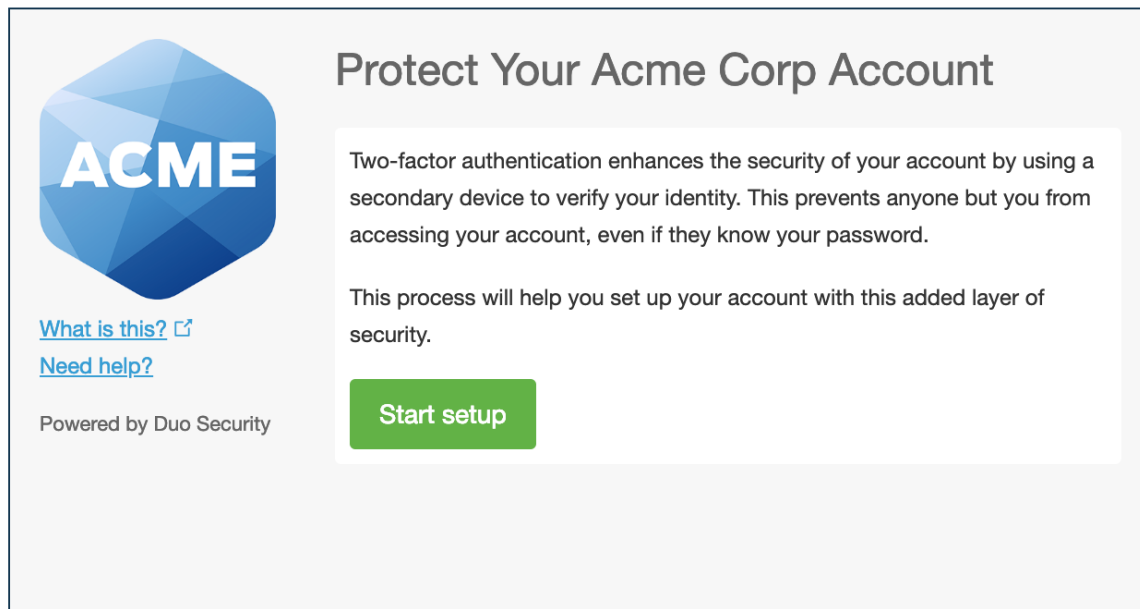

## Protect Your Acme Corp Account

Two-factor authentication enhances the security of your account by using a secondary device to verify your identity. This prevents anyone but you from accessing your account, even if they know your password.

This process will help you set up your account with this added layer of security.

[What is this?](#) [Need help?](#)

Powered by Duo Security

[Start setup](#)

## 2. Choose Your Authentication Device Type

Select the type of device you'd like to enroll and click **Continue**. We recommend using a smartphone for the best experience, but you can also enroll a landline telephone, [a security key](#), or iOS/Android tablets.

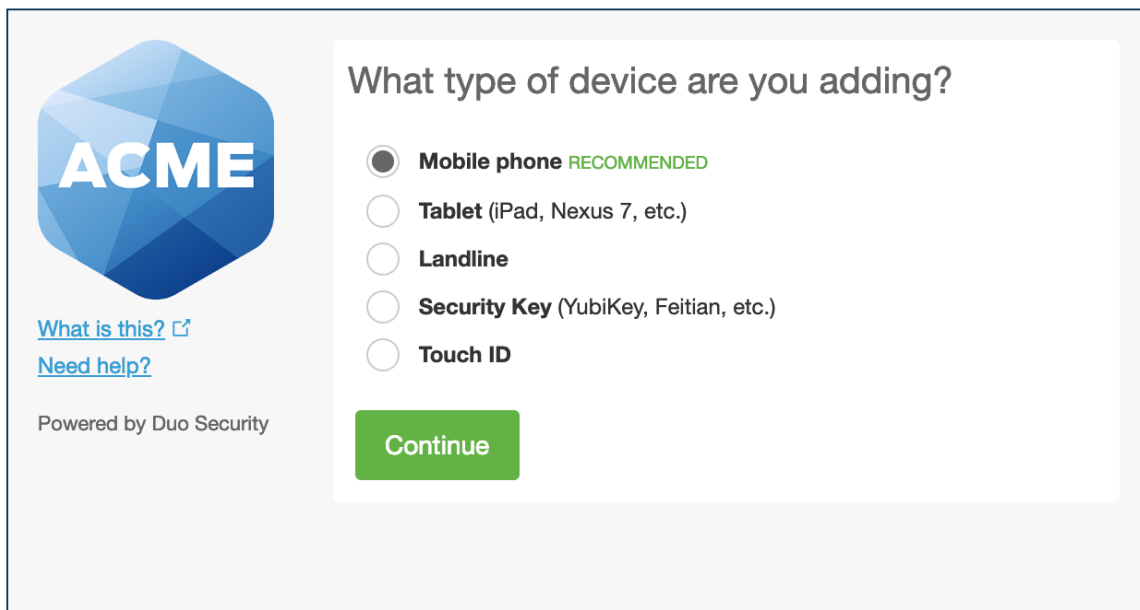

## What type of device are you adding?

**Mobile phone** RECOMMENDED

**Tablet** (iPad, Nexus 7, etc.)

**Landline**

**Security Key** (YubiKey, Feitian, etc.)

**Touch ID**

[What is this?](#) [Need help?](#)

Powered by Duo Security

[Continue](#)

## 3. Type Your Phone Number

Select your country from the drop-down list and type your phone number. Use the number of your smartphone, landline, or cell phone that you'll have with you when you're logging in to a Duo-protected service. You can enter an extension if you chose "Landline" in the previous step.

Then double-check that you entered it correctly, check the box, and click **Continue**.

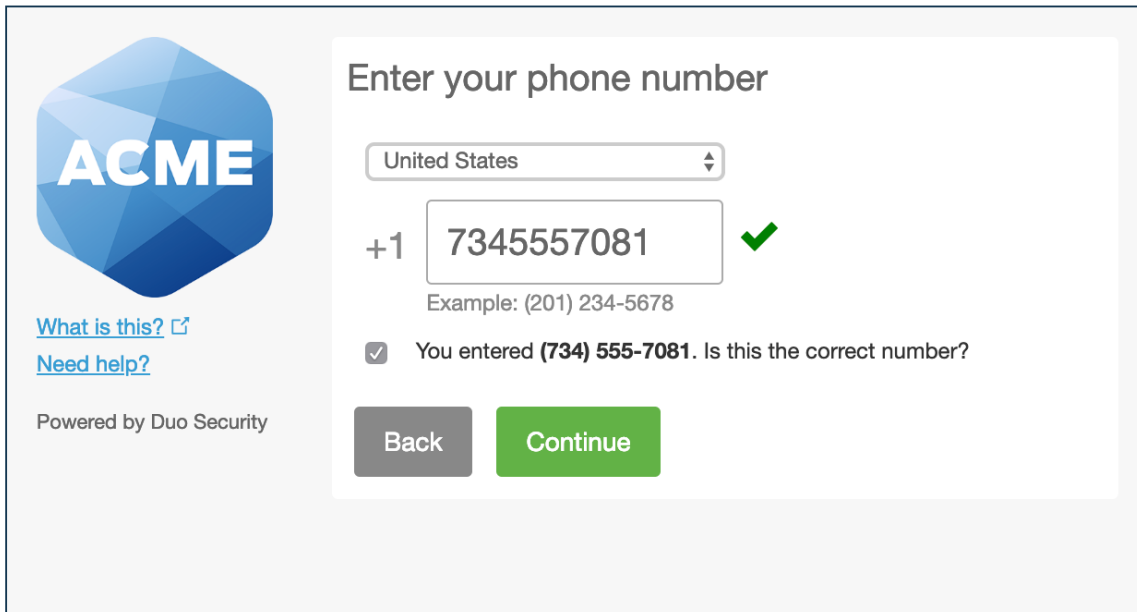

ACME

[What is this?](#) [Need help?](#)

Powered by Duo Security

### Enter your phone number

United States

+1 7345557081 ✓

Example: (201) 234-5678

You entered **(734) 555-7081**. Is this the correct number?

Back Continue

If you're enrolling a tablet you aren't prompted to enter a phone number.

## 4. Choose Platform

Choose your device's operating system and click **Continue**.

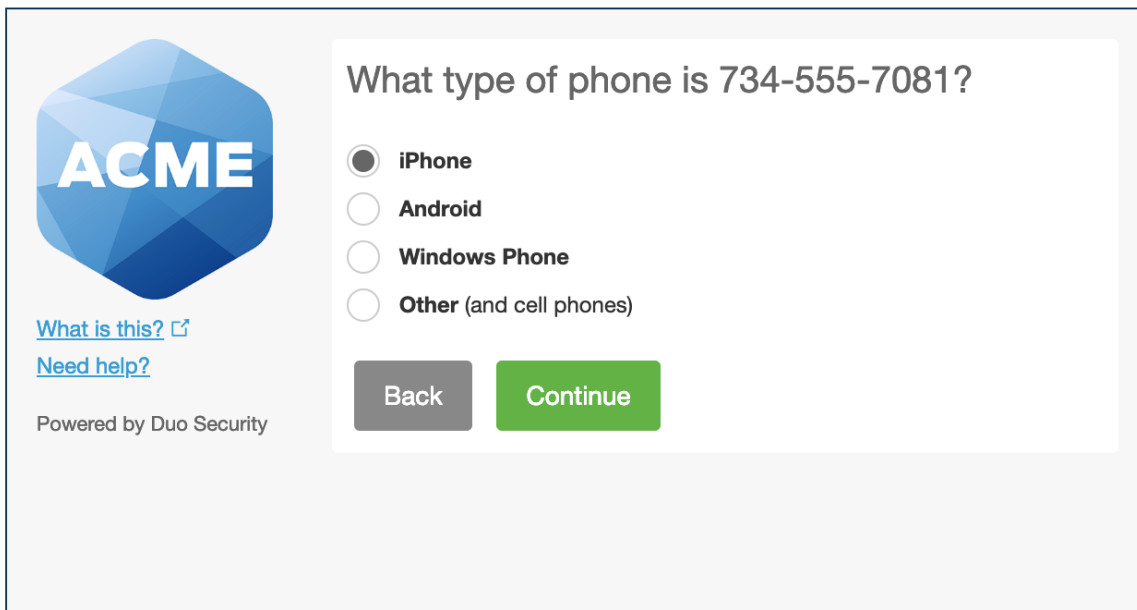

ACME

[What is this?](#) [Need help?](#)

Powered by Duo Security

### What type of phone is 734-555-7081?

iPhone

Android

Windows Phone

Other (and cell phones)

Back Continue

## 5. Install Duo Mobilez

Duo Mobile is an app that runs on your smartphone and helps you authenticate quickly and easily. Without it you'll still be able to log in using a phone call or text message, but for the best experience we recommend that you use Duo Mobile.

### Why use Duo Mobile?

- It's fast & easy
- Works in any country
- Doesn't require cell service

Follow the platform-specific instructions on the screen to install Duo Mobile. After installing our app return to the enrollment window and click **I have Duo Mobile installed**.

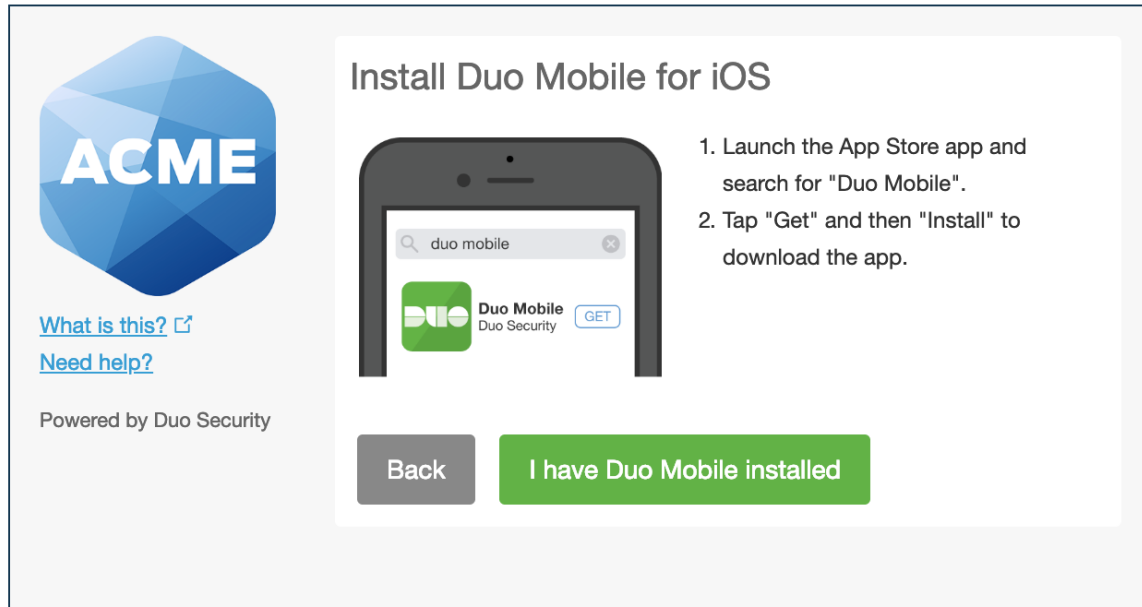

## 6. Activate Duo Mobile

Activating the app links it to your account so you can use it for authentication.

On iPhone, Android, and Windows Phone activate Duo Mobile by scanning the barcode with the app's built-in barcode scanner. Follow the platform specific instructions for your device:

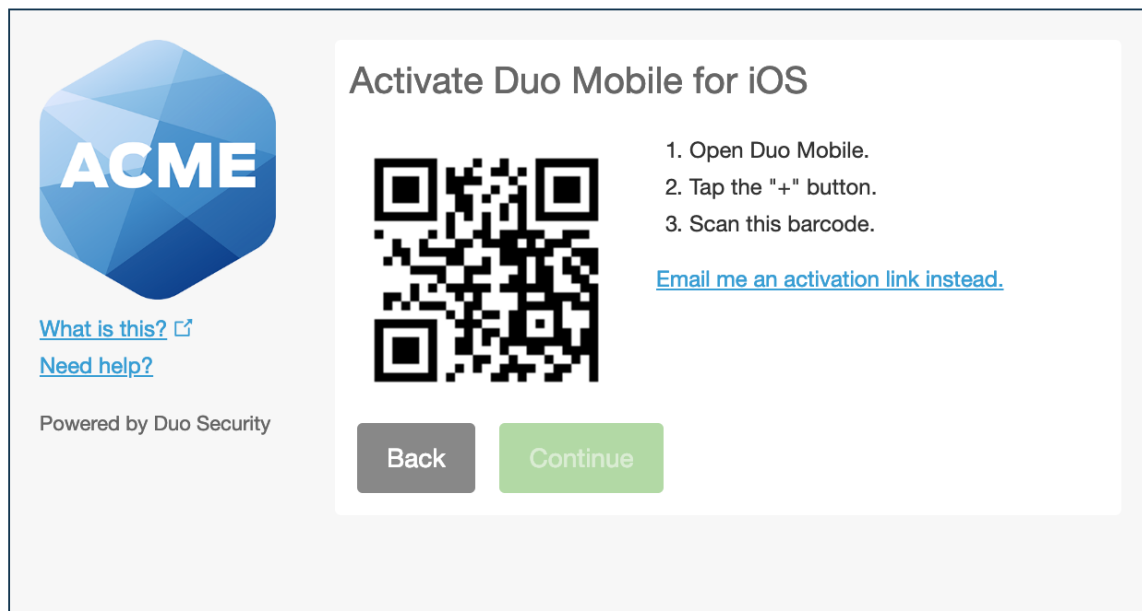

The "Continue" button is clickable after you scan the barcode successfully.

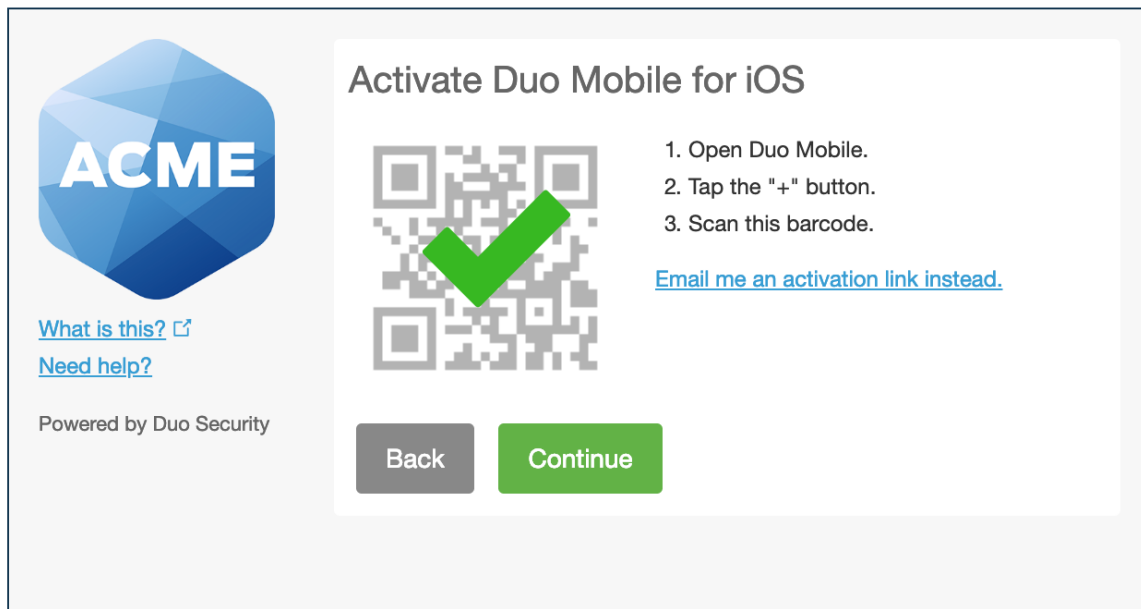

Can't scan the barcode? Click **Or, have an activation link emailed to you instead.** and follow the instructions.

## 7. Configure Device Options (optional)

You can use **Device Options** to give your phone a more descriptive name, or you can click **Add another device** to start the enrollment process again and add a second phone or another authenticator.

If this is the device you'll use most often with Duo then you may want to enable automatic push requests by changing the **When I log in:** option and changing the setting from "Ask me to choose an authentication method" to "Automatically send this device a Duo Push" or "Automatically call this device" and click **Save**. With one of the automatic options enabled Duo automatically sends an authentication request via push notification to the Duo Mobile app on your smartphone or a phone call to your device (depending on your selection).

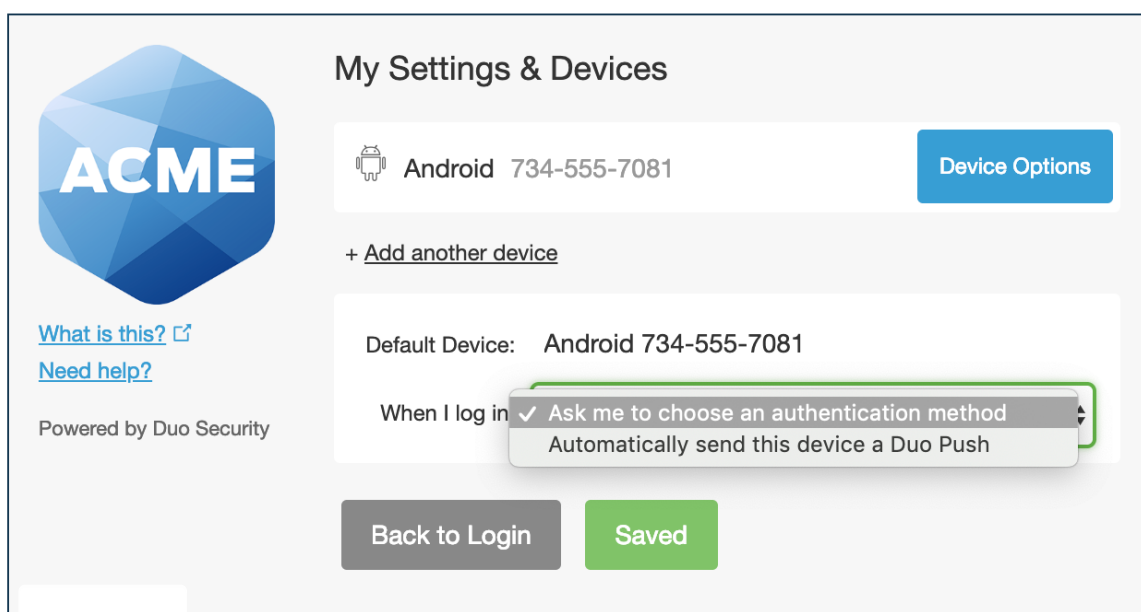

Click **Continue to login** to proceed to the Duo Prompt.

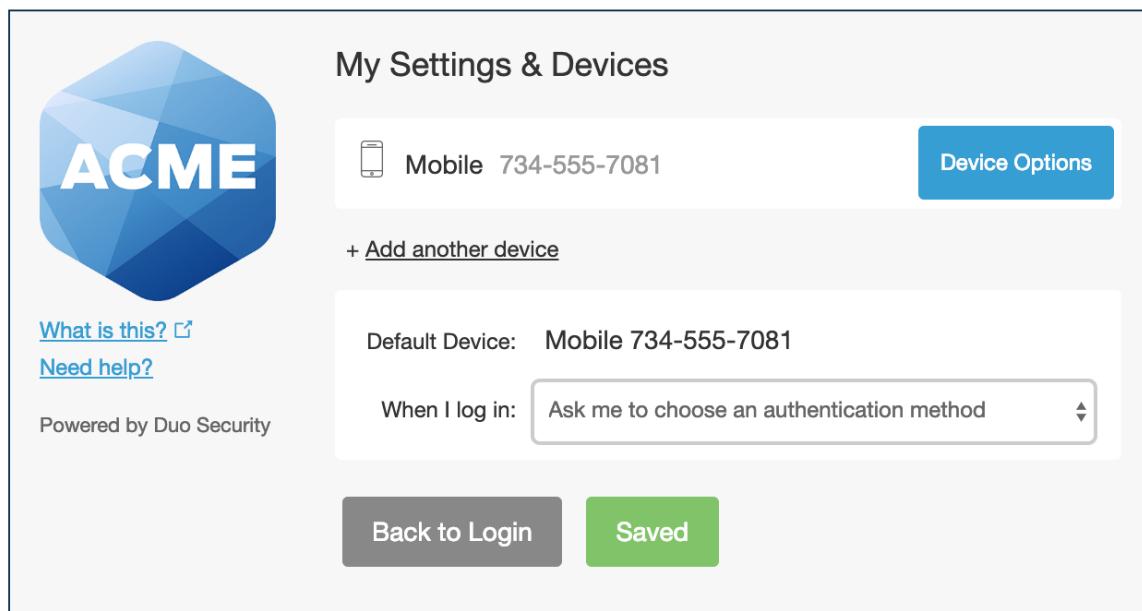

**ACME**

[What is this?](#) [Need help?](#)

Powered by Duo Security

### My Settings & Devices

Mobile 734-555-7081 [Device Options](#)

+ [Add another device](#)

Default Device: Mobile 734-555-7081

When I log in: Ask me to choose an authentication method

[Back to Login](#) [Saved](#)

## Congratulations!

Your device is ready to approve Duo authentication requests. Click **Send me a Push** to give it a try. All you need to do is tap **Approve** on the Duo login request received at your phone.

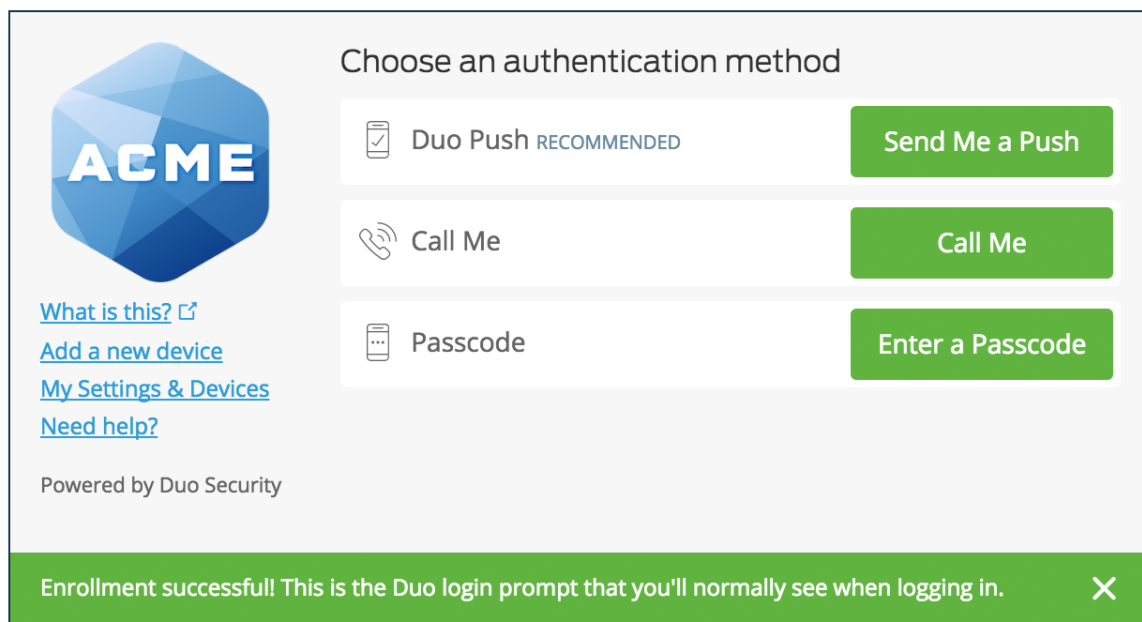

**ACME**

[What is this?](#) [Add a new device](#) [My Settings & Devices](#) [Need help?](#)

Powered by Duo Security

### Choose an authentication method

Duo Push **RECOMMENDED** [Send Me a Push](#)

Call Me [Call Me](#)

Passcode [Enter a Passcode](#)

Enrollment successful! This is the Duo login prompt that you'll normally see when logging in. [X](#)

## Add or Manage Devices

If enabled by your administrator, you can [add a new authentication device](#) or [manage your existing devices](#) in the future via the Duo Prompt.

Otherwise, contact your organization's Duo administrator if you ever need to change your phone number, reactivate Duo Mobile, or add an additional phone.